

St. Peter-in-the-Wood, Appleshaw Church

Updating the church for the 21st Century



Introduction

There is a constant requirement for renovation and maintenance of historic buildings. This poster summarises the steps being taken to update Appleshaw church for the 21st century.

Quinquennial report

In order to ensure that churches in England comply with prevailing regulations and are appropriately maintained, the Church of England conducts a formal review via its Quinquennial Report process, which occurs every five years. The latest St. Peter-in-the-Wood Quinquennial report of 2014 identified a number of issues that need to be addressed, including:

- repainting the interior and external chalk walls
- repairing and repainting the window frames
- repairing the lead roof
- maintenance of gutters
- safety improvements to the gallery
- repairs to the boundary wall

Opportunity to modernise the church

The maintenance & repairs identified in the Quinquennial report also provide an opportunity to carry out modernisation work to bring the church up-to-date for the 21st Century, including:

- installation of energy-efficient heating and lighting
- installation of plumbing to provide water and waste services
- specialist repairs to stained-glass windows, some of which date back more than 100 years
- overhaul of the nearly 100-year old organ
- remodelling & updating of the vestry

Vestry renovation – modern kitchen and toilet facilities

In the 1980s, a partition wall was erected to create a closed-off area for use by the clergy and to provide storage facilities.

In order to use the space more efficiently and to provide appropriate modern services, kitchen and toilet facilities are being installed in the vestry. These improvements will enable the church to be used for a broader range of activities.

We are also ensuring that there is wheelchair access to the vestry.

Funding

Work on historic buildings is always expensive and the costs anticipated to carry out the maintenance and modernisation are not insubstantial.

We plan to raise the necessary funds via three different routes:

- donations
- monies from different specialist charities or grant-giving organisations
- specific fundraising & sponsorship events

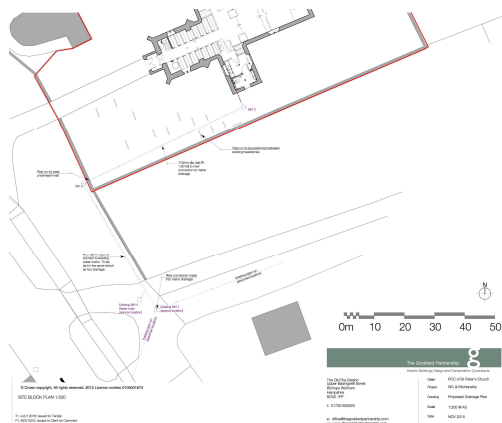
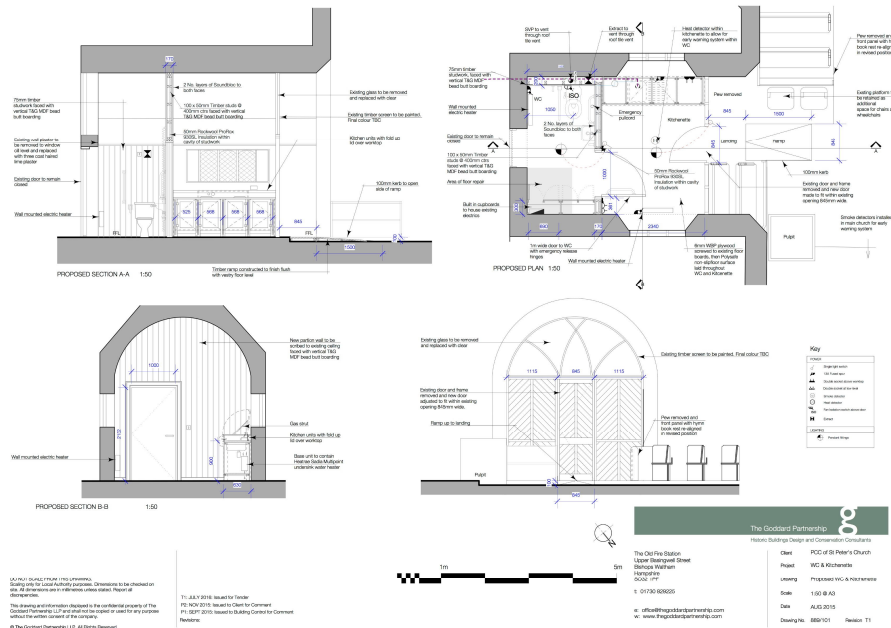

Continuing - and expanded - use of the church in the 21st Century

Appleshaw church continues to be used for regular church services as well as special events such as christenings, weddings & funerals. The church is open on a daily basis for quiet contemplation and reflection. In addition, the church is available for use by the local community for gatherings such as talks & concerts. The programme of modernisation summarised above will enable St Peter-in-the-Wood to provide an historic and attractive venue with up-to-date facilities for a variety of different events in the future.

Further information & participation in fundraising activities

If you would like further information, wish to make a donation or would be happy to help with a fundraising event, please contact any member of the Parish Church Council.

www.appleshaw.org.uk